



GE-100-A

RIVER BEND



INDUSTRIES

Moorhead, MN 56560
218-236-1818
800-365-3070
www.riverbendind.com

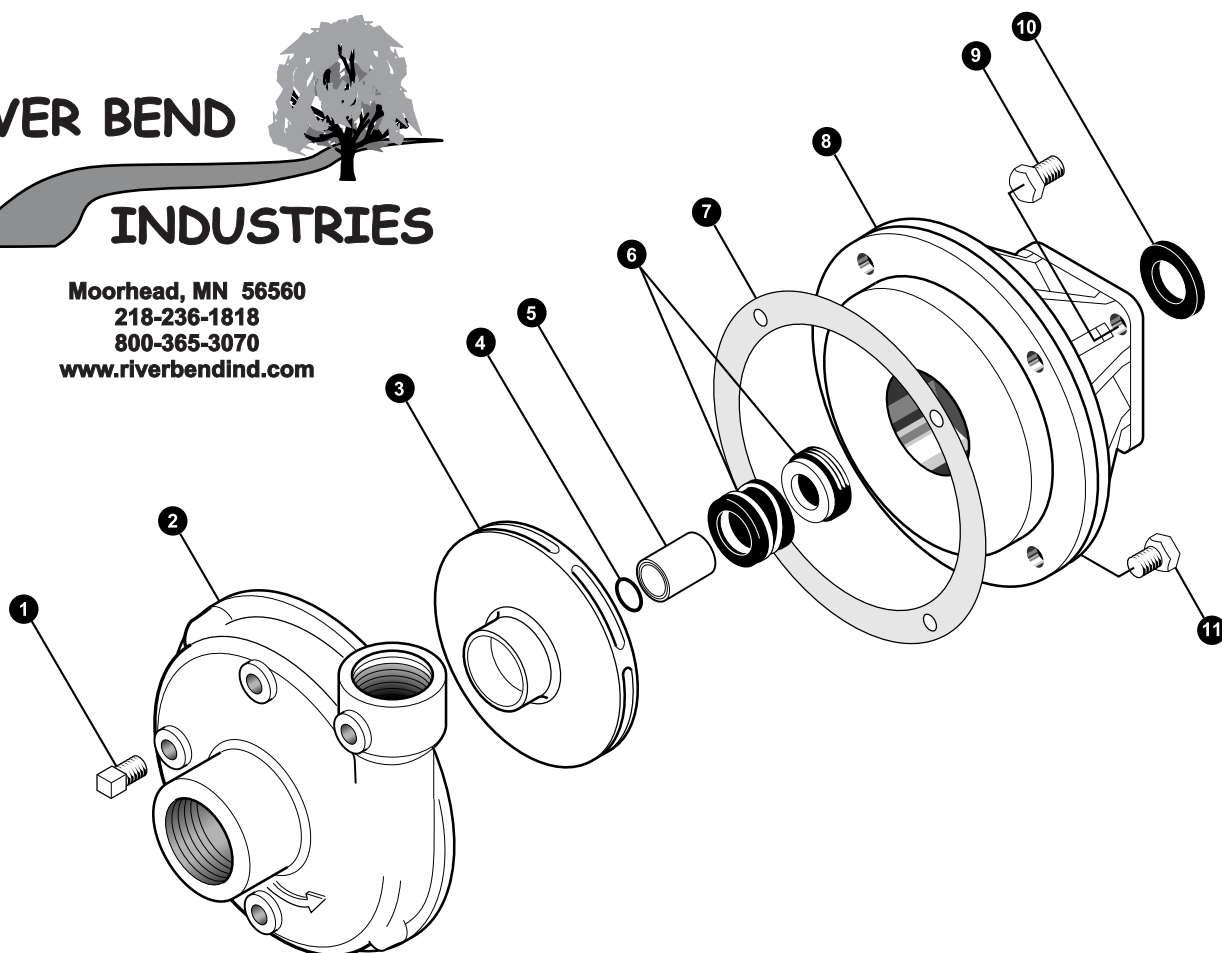

REF. #	PART #	EDP #	DESCRIPTION	REQ.
1	BAC-53	41110	Pipe Plug, 1/8" NPT	4
1	41120	41120	Pipe Plug, 1/8" NPT Stainless Steel (Optional)	4
2	5AC-10	30100	Volute, 1-1/4" x 1", Cast Iron	1
3	GE-26-A	42161	Impeller, Cast Iron, Right Hand 5/8" Thread	1
4*	GE-8-V-A	42132	O-Ring, Shaft Sleeve, Viton	1
5	GE-6-SS-A	42105	Sleeve for 1" OD Shaft, Stainless Steel	1
6*	GE-7-V	42120	Seal, 1" Type 6 Mechanical Seal, Viton	1
7*	31040	34040	Gasket, Volute, 4 Hole	1
8	GE-9-A	42151	Bracket, Cast Iron	1
9	GE-60	42230	Cap Screw, 5/16" NC x 3/4"	4
9	GE-60-SS	42235	Cap Screw, 5/16" NC x 3/4" Stainless Steel (Optional)	4
10	GE-54	42220	Slinger	1
11	40950	40950	Cap Screw, 3/8" NC x 3/4"	4
11	40930	40930	Cap Screw, 3/8" NC x 3/4" Stainless Steel (Optional)	4
#	GE-1-A	42060	3-1/2 HP Gasoline Engine, Briggs & Stratton	1
#	GE-2	42070	Handle (Optional)	1
#	GE-3	42080	Steel Base (Optional)	1
#	GE-62	42250	Cap Screw, 5/16" NC x 1-1/2", Engine to Base	4
#	42270	42270	Nut, 5/16" NC Hex, Engine to Base	4
#	RK-GE-100-A	60855	Repair Kit for GE-100-A	--

* Items included in pump repair kit.