

Banjo 222 Series Pump

RIVER BEND

INDUSTRIES

Moorhead, MN 56560

218-236-1818

800-365-3070

www.riverbendind.com

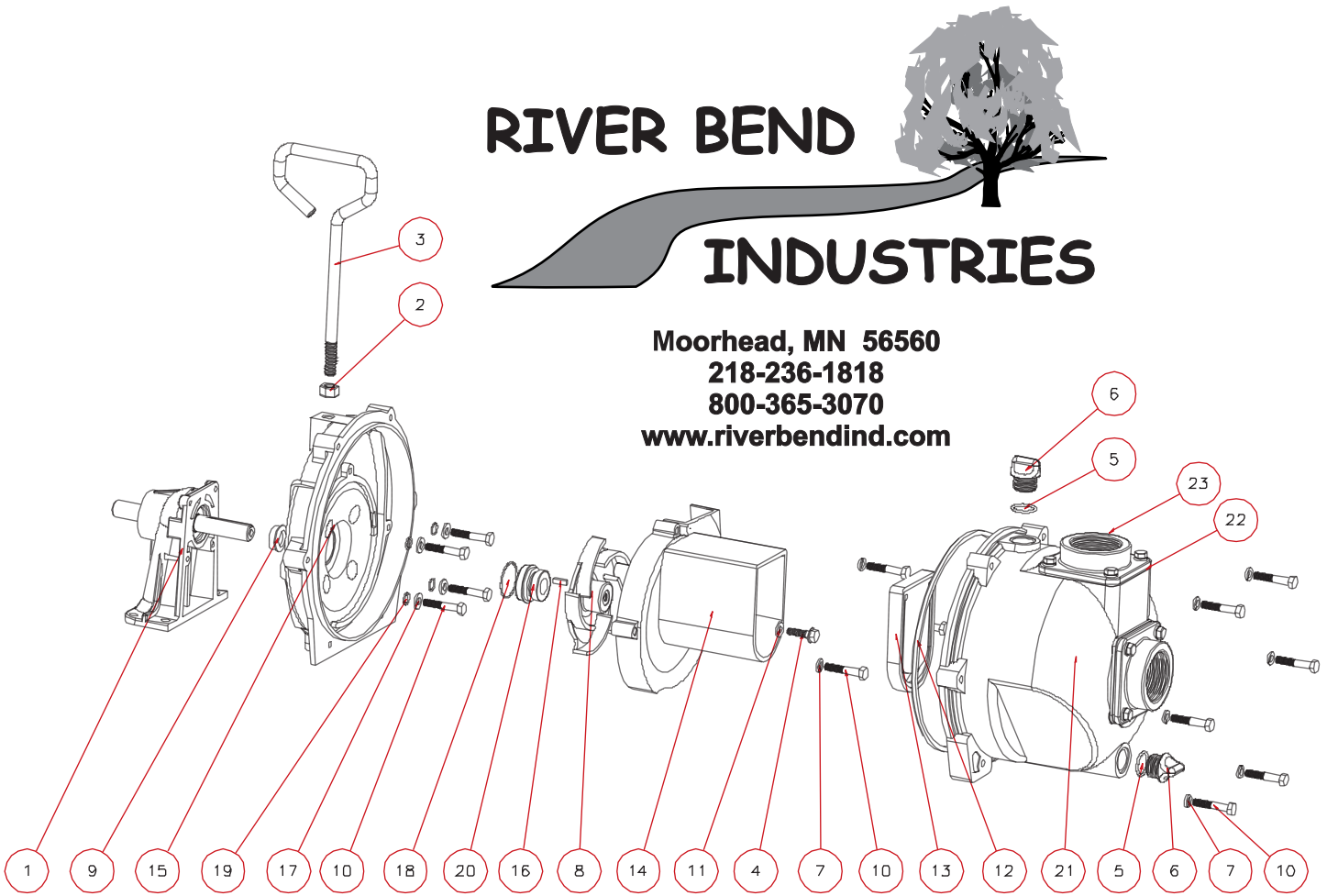

REPLACEMENT PARTS 222 SERIES CAST IRON PUMPS

REF. NO.	PART NO.	DESCRIPTION	QTY. PER PUMP	REF. NO.	PART NO.	DESCRIPTION	QTY. PER PUMP
1	12882A	Bearing Pedestal Assembly	1	17	12901	⁵ / ₁₆ " Flat Washer	4
1	12600B	Hydraulic Pedestal Assembly	1	18	12710	2-029 O-Ring	1
2	17010*	¹ / ₂ " Jam Nut	1	19	12717*	2-011 O-Ring	4
3	15022	2" Pump Handle	1	20	12713V*	Seal Assembly	1
4	12765A	⁵ / ₁₆ -24 x 1.12 Impeller Bolt	1	20	12713SD	Severe Duty Seal	1
5	13778*	2-119 O-Ring	2	21	15712	Pump Body Assembly	1
6	13777	Prime/Drain Plug	2	22	17013	Flange Gasket	2
7	V10118	⁵ / ₁₆ " Lockwasher	9	23	17000	Threaded Flange	2
8	15772	5 Vane Impeller*	1	N/S	15751*	Bracket Shim	AS REQ 'D
9	12716	Pump Slinger	1	N/S	17033	Z-Rails (PR)	1 PAIR
10	12715A	HHCS ⁵ / ₁₆ -24x1.75	13	N/S	17034	HHCS ⁵ / ₁₆ -18 X 1 ³ / ₄ " Zinc Plated	4
11	12774VA*	Impeller Bolt Gasket	1	N/S	V10119	⁵ / ₁₆ "-18 Hex Nut	4
12	12719A*	2-375 Body O-Ring	1	N/S	V10118	⁵ / ₁₆ " Lockwasher	4
13	12705*	Check Valve	1	N/S	15000*	REPAIR KIT	1
14	15702	Volute	1	N/S	15999	SEAL KIT (repair kit w/o impeller)	1
15	15703	Rear Bracket	1	N/S	15000V	REPAIR KIT FKM (viton type)	1
16	12902A	³ / ₁₆ sq x ⁵ / ₈ " Key*	1	N/S	15999V	SEAL KIT FKM (viton type)	1

Pump Repair Kits Contain Items Marked With Asterisk

NOTE: EPDM Gaskets, Seals and O-rings used in the following assemblies unless otherwise noted: 222PBI, 222PIHY, 222PI5, 222PIH5, 222POI. Pumps equipped with FKM (viton type) also available.