

Banjo 1-1/2" and 2" Poly Gas and Pedestal Pumps

RIVER BEND



INDUSTRIES

Moorhead, MN 56560
218-236-1818
800-365-3070
www.riverbendind.com

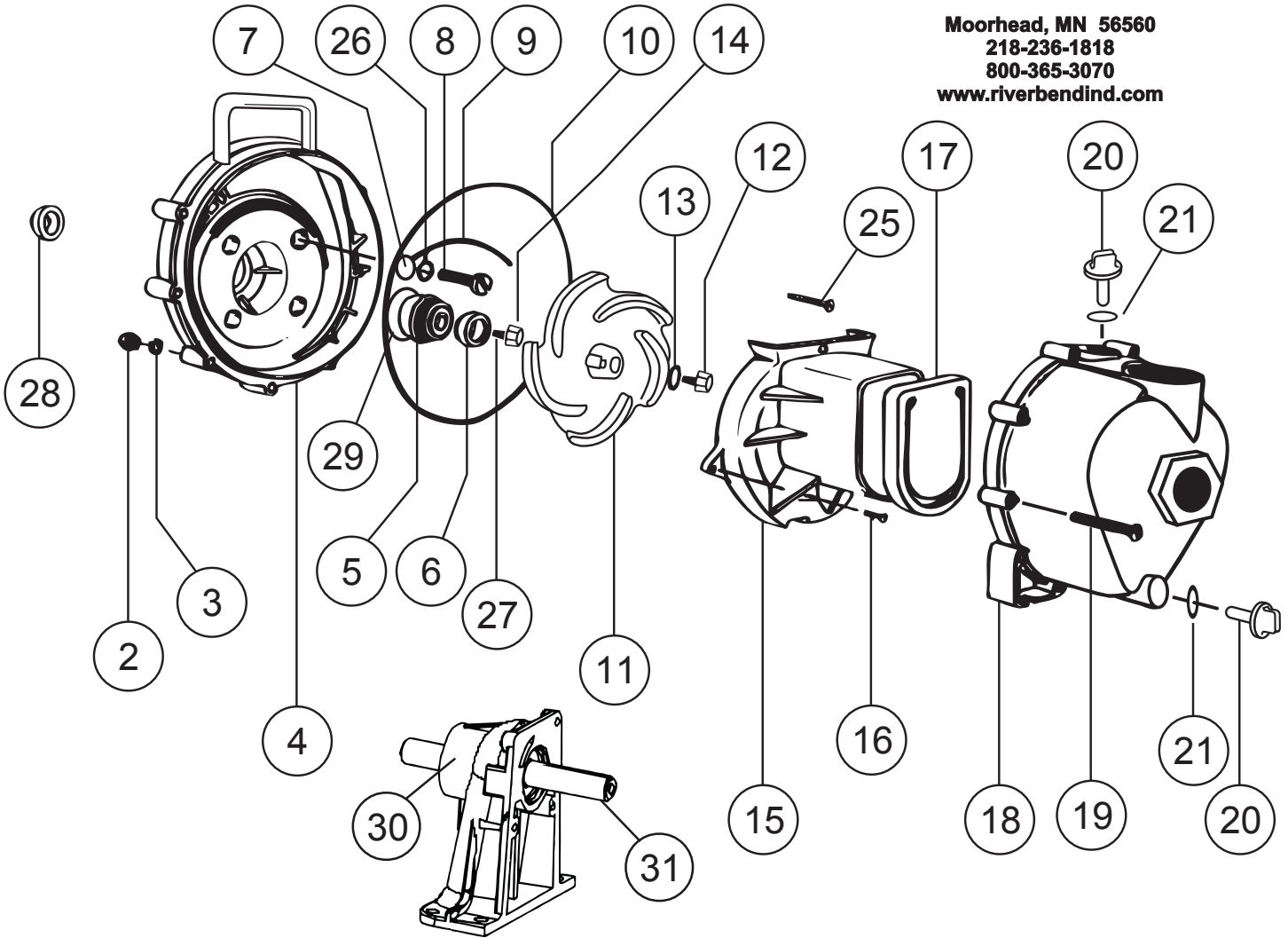

REPLACEMENT PARTS FOR PUMPS MANUFACTURED BEGINNING SEPT. 1996

ITEM	DESCRIPTION	PER PUMP	PART NUMBER	
			1-1/2"	2"
2	Body Nuts SS	10	V07019	V07019
3	Lock Washer SS	10	V07018	V07018
4	Poly Pump Rear Bracket	1	12703A	12703A
5 & 6	Seal Assembly*+	1	12713	12713
7	Screw Heads "O" Ring*+	4	12717	12717
8	Bracket Screws SS	4	12715A	12715A
9	O-Ring Segment*+	1	12784	12784
10	Body O-Ring*+	1	12719A	12719A
11	3 Vane Poly Pump Impeller+ 3.5 h.p.	1	12771A	
	5 Vane Poly Pump Impeller+ 5.5 h.p.	1		12772
12	Impeller Bolt SS	1	12765A	12765A
13	Impeller Bolt Gasket*+	1	12774VA	12774VA
14	Impeller Hex Nut	1	12775A	12775A
15	Poly Pump Volute	1	12702A	12702A
16	Volute Screws SS	2	12725	12725
17	Poly Pump Check Valve+	1	12705	12705

ITEM	DESCRIPTION	PER PUMP	PART NUMBER	
			1-1/2"	2"
18	Poly Pump Body Assembly	1	12711A	12712A
19	Body Screws SS	10	12720	12720
20	Prime / Drain Plug	2	12777	12777
21	Prime / Drain Plug O-Ring	2	UV15163	UV15163
25	Upper Volute Screw SS	1	12900	12900
26	Rear Bracket Washer SS	4	12901	12901
27	Impeller Key	1	12902A	12902A
28	Poly Pump Slinger*+	1	12716	12716
29	O-Ring for Seal Assembly*+	1	12710	12710
30	Complete Bearing Pedestal	1	12882A	12882A
31	Bearing Shaft	1	12883	12883
	Pump Repair Kit — 3 Vane Impeller (Consists Of Items Marked With +)	1	12003A	
	Pump Repair Kit — 5 Vane Impeller (Consists Of Items Marked With +)	1		12000A
	Pump Seal/O-Ring Kit (Consists Of Items Marked With *)	1	12999A	12999A