

# RIVER BEND



# INDUSTRIES

Moorhead, MN 56560

218-236-1818

800-365-3070

www.riverbendind.com



## 3" Cast Iron Pump

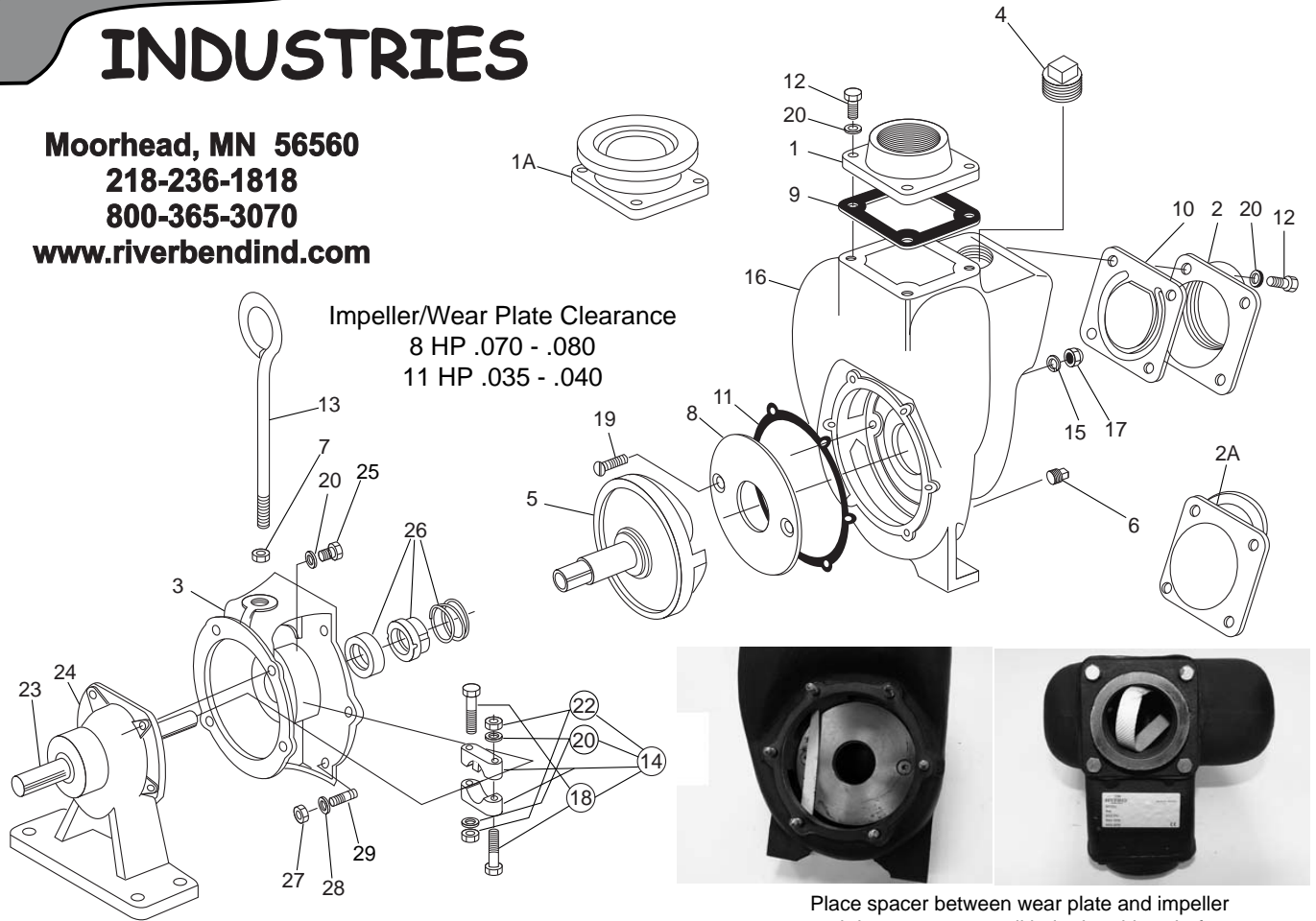

Impeller/Wear Plate Clearance  
 8 HP .070 - .080  
 11 HP .035 - .040

### REPLACEMENT PARTS 3" Cast Iron Pump

REF. NO.	PART NO.	DESCRIPTION	QTY. PER PUMP	REF. NO.	PART NO.	DESCRIPTION	QTY. PER PUMP
1	18008	Flange, Outlet 3" NPT	1	15*	18005	Gasket, Wear Plate	2
1A	M18008	Flange, Outlet 3" Manifold	1	16	18001	3" Pump Housing	1
2	18012	Flange Inlet 3" NPT	1	17	18007	3/8" - 16 SS Acorn Nut	2
2A	M18012	Flange Inlet 3" Manifold	1	18	18030	Bolt 3/8" - 24 x 21/4" Large	2
3	18026	Gas Engine Adapter	1	19*	18106	Wear Plate Screw	2
3	18048	3" C-Flange Adapter	1	20	V20018	Lock Washer 3/8"	8
3	18049	C.I. Hydraulic Motor Adapter 3"	1	22	18032	Nut 3/8" x 24 Hex SS	2
N/S	18055	Hydraulic Adapter Shaft 3"	1	23	18504	1" Shaft For 3" Pedestal.	1
4	18002	Plug 1" PT Flush	1	24	18500	3" Bearing Pedestal - Complete	1
5*	18023	Impeller & Drive Shaft 1" (Gas Engine)	1	N/S	18502	Bearing	2
5	18023-1.125	Impeller & Drive Shaft 1-1/8" (Elec.Motor)	1	25	17704	Bolt	4
6	18003	Plug 1/2" NPT	1	26*	18025	Seal Assy. FKM (viton type)	1
7	18034	Nut, Jam 5/8" - 11 Thread SS	1	26	18025SD	Severe Duty Seal	1
8*	18004	Wear Plate	1	27	V20019	Nut 3/8" - 24, Hex SS	6
9	18009	Gasket, Outlet EPDM	1	28	V20018	Washer 3/8" Lock SS	6
9	18009BN	Gasket, Outlet BUNA	1	29	18218	Stud 3/8"-16 x 3/8"- 24 x 11/2" LG SS	6
10	18013	Gasket Check Valve Assy. EPDM	1	N/S	18035	Z-Rail Mtg. Bracket.	1 Pr.
10	18013BN	Gasket Check Valve Assy. BUNA	1	N/S	18100	3" Pump Repair Kit (Consists of items marked *)	1
11*	18021	Gasket, Adapter	1				
12	18010	SS Capscrew HX HD 3/8"-16 x 11/8" LG SS	8				
13	18033	Handle 5/8 - 11 Thread.	1				
14	18029	Clamp Assy. SS (Old Style)	1 Assy.				
14	18129	Clamp Assy. SS (Keyed)	1 Assy.				