

4900 Roller Pump

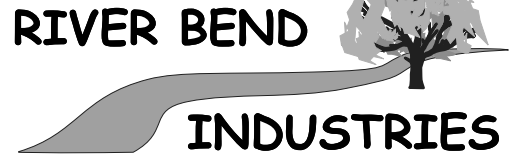
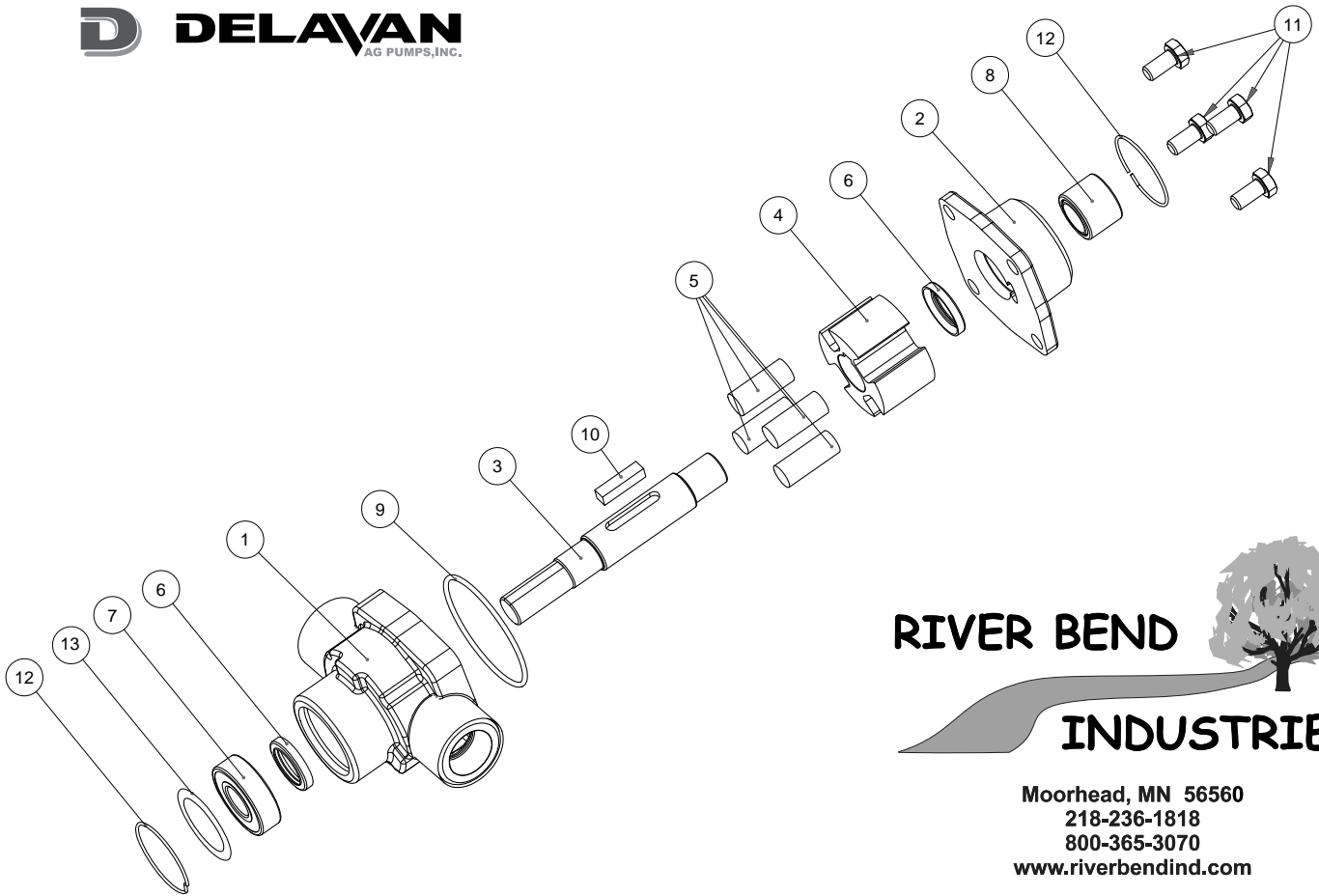

Moorhead, MN 56560
 218-236-1818
 800-365-3070
www.riverbendind.com

4900 Series RollerPRO[®] Pump Parts

Ref #	Part#	Description	Qty/ Pump
1	—	Body	1
2	—	End Plate	1
3	31410	Shaft – 5/8" solid	1
	31415	Hollow shaft – 1/2"	
4	36410	4-Roller Rotor for Cast Iron Models	1
	36415	4-Roller Rotor for Diamond SS Models	
5	48234	Ultra Rollers 1/2" Diameter	4
6	37801	Shaft Seal	2
7	15072	Ball Bearing	1
8	38801	Needle Bearing	1
9	31350-142	Seal Ring	1
10	40801	Shaft Key	1
11	—	Hex Head Screw- 5/16-18UNX x 5/8"	4
12	15070	Snap Ring	2
13		Name Plate:	1
	40410-1	4900C (Cast Iron)	
	40410-5	4901C (Cast Iron Hollow Shaft)	
	40410-3	4900DSS (Diamond Stainless Steel)	
	40410-6	4901DSS (Diamond Stainless Steel Hollow Shaft)	

RollerPRO[®] Repair Kit

Part #: RK-4900 Complete kit of all parts for repair of all 4-RollerPRO Pump models Including:

Part #	Description	Qty/Kit
48234	Ultra Rollers 1/2" Diameter	4
37801	Shaft Seal	2
31350-142	Seal Ring	1
40801	Shaft Key	1

Accessories

Torque Bar and Chain Part #: 33680
 Required to anchor PTO-mounted pumps in order to keep pump from rotating with the shaft

Coupler Part #: 50101
 For 5/8" diameter electric motor or gas engine; 5/8" pump shaft; 2600 RPM; mild steel with set screws