

# 8900 Roller Pump

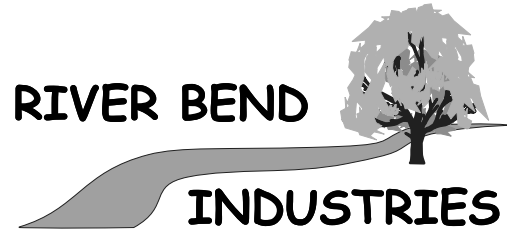
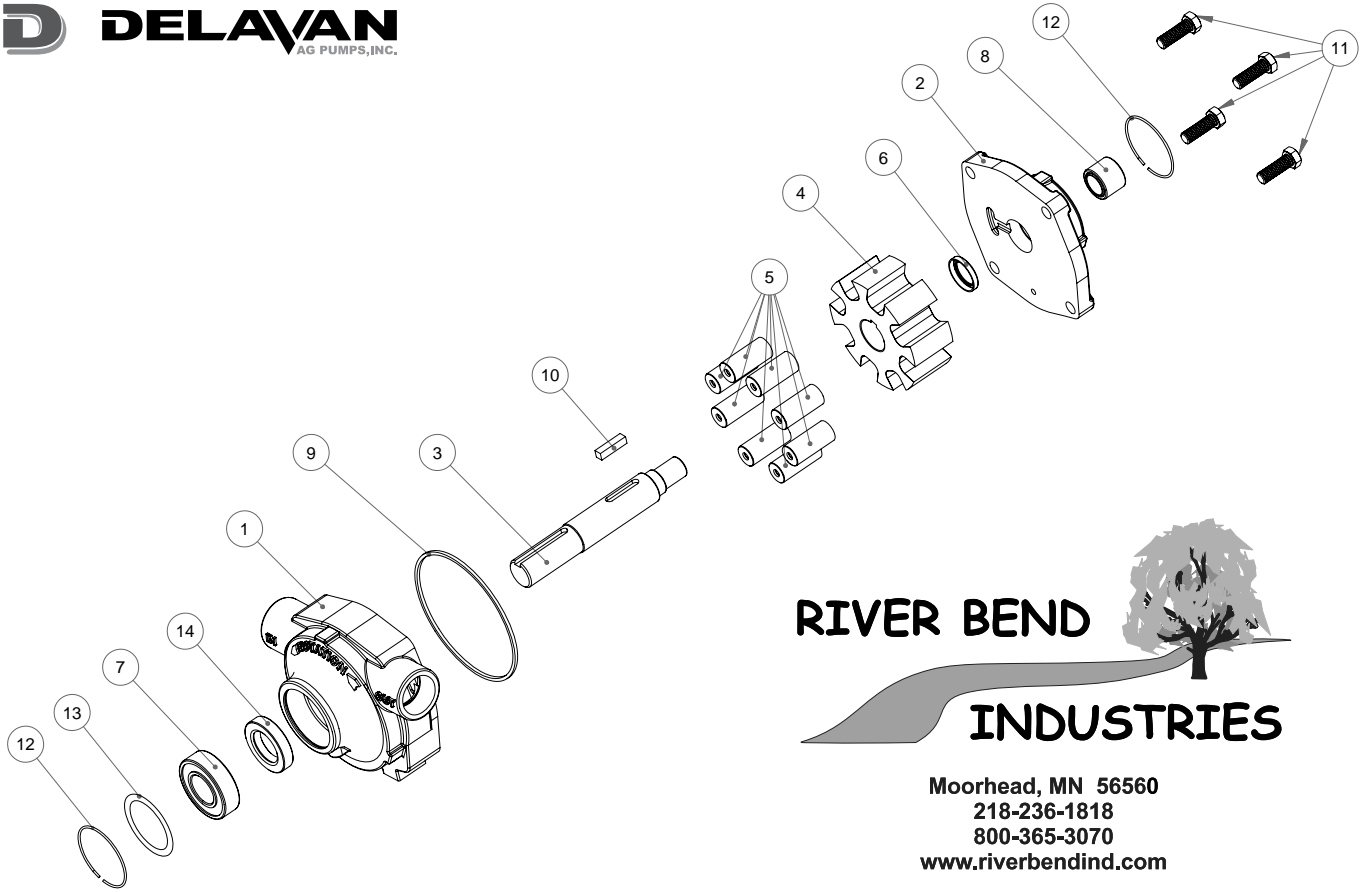

Moorhead, MN 56560  
 218-236-1818  
 800-365-3070  
[www.riverbendind.com](http://www.riverbendind.com)

## 8900 Series RollerPRO<sup>®</sup> Pump Parts

Ref #	Part#	Description	Qty/ Pump
1	—	Body	1
2	—	End Plate	1
3	31810	Shaft	1
4	36801	8-Roller Rotor for Cast Iron Models	1
	36802	8-Roller Rotor for Diamond SS Models	
5	19341	Ultra Rollers 11/16" Diameter	8
6	37801	Shaft Seal	1
7	16228	Ball Bearing	1
8	38801	Needle Bearing	1
9	24829	Seal Ring	1
10	40801	Shaft Key	1
11	—	Hex Head Screw- 3/8-16UNC x 1-1/8"	4
12	15334	Snap Ring	2
13		Name Plate:	1
	40810-1	8900C (Cast Iron)	
	40810-2	8900C-R (Cast Iron Reverse Rotation)	
	40810-3	8900DSS (Diamond Stainless Steel)	
	40810-4	8900DSS-R (Diamond Stainless Steel Reverse Rotation)	
14	47927	Lip Seal	1

## RollerPRO<sup>®</sup> Repair Kit

Part #: RK-8900 Complete kit of all parts for repair of all 8-RollerPRO Pump models Including:

Part #	Description	Qty/Kit
19341	Ultra Rollers 11/16" Diameter	8
37801	Shaft Seal	1
47927	Lip Seal	1
24819	Seal Ring	1
40801	Shaft Key	1

## Accessories

- Torque Bar and Chain Part #: 33680  
Required to anchor PTO-mounted pumps in order to keep pump from rotating with the shaft
- Coupler Part #: 35735  
For 1-3/8" diameter PTO; 15/16" pump shaft; 540 RPM; forged steel body, nylon collar\*
- Coupler Part #: 46814-3  
For 1-3/8" diameter PTO; 15/16" pump shaft; dual speed 540-1000 RPM; corrosion-resistant cast aluminum, nylon collar\*
- Coupler Part #: 35979  
For 1-3/8" diameter PTO; 15/16" pump shaft; 1000 RPM; forged steel body, nylon collar\*

\*Mounting hardware included