

# DEMCO Lil' Thumper Pump OLD STYLE

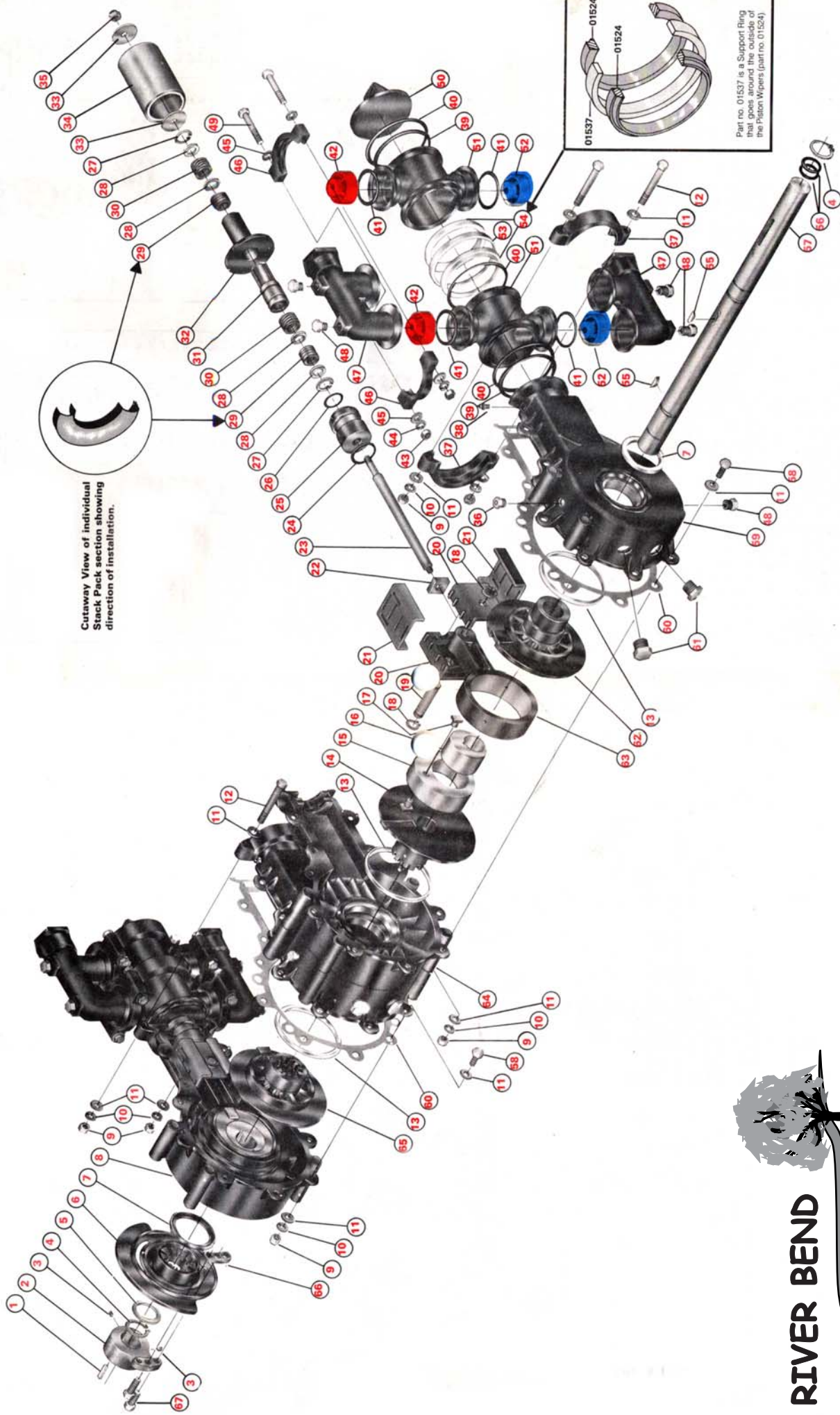

Cutaway View of individual Stack Pack section showing direction of installation.

01537 — 01524  
Part no. 01537 is a Support Ring that goes around the outside of the Piston Wipers (part no. 01524).

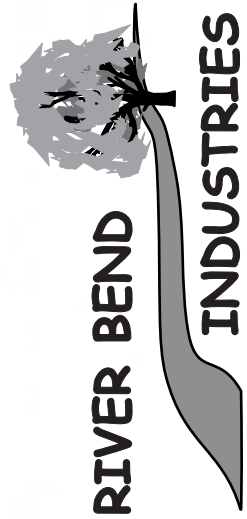

**RIVER BEND**

**INDUSTRIES**

Moorhead, MN 56560  
218-236-1818  
800-365-3070  
[www.riverbendind.com](http://www.riverbendind.com)

30W Non Detergent Oil for  
Drive Case

# OLD STYLE Lil Thumper Pump

REF. NO.	ORDER NO.	QTY. REQ'D.	DESCRIPTION	REF. NO.	ORDER NO.	QTY. REQ'D.	DESCRIPTION
1	01989	1	1/4" X 1/4" 1" Key	36	01597	2	1/4" Nylon Male Pipe Thread Breather Plug
2	01191	1	Adjustment Pointer	37	01535	12	Large Clamp
3	01990	2	5/16" -18 UNC X 3/8" long Set Screw	38	01999	2	Grease Zerk
4	01528	2	Main Shaft Snap Ring	39	01520	4	Cylinder Housing Small O-Ring
5	01979	1	1-1/4" I.D. 18 gauge Machine Bushing	40	01521	6	Cylinder Housing Large O-Ring
6	01176	1	Adjustment Disc	41	01522	8	Check Valve O-Ring
7	01517	2	Drive Hub Oil Seal	42	01321	4	Exhaust Manifold Check Valve (RED)
8	01180	1	Left Half Drive Case	43	02000	16	1/4" -20 UNC Stainless Steel Hex Nut
9	01996	34	5/16" -18 UNC Stainless Steel Hex Nut	44	02001	16	1/4" Stainless Steel Lock Washer
10	01997	34	5/16" Stainless Steel Lock Washer	45	02002	32	1/4" Stainless Steel Flat Washer
11	01998	68	5/16" Stainless Steel Flat Washer	46	01539	16	Small Clamp
12	02005	12	5A6" -18 UN-Cx3" long Stainless Steel Hex Head Bolt	47	01536	4	Intake / Exhaust Manifold
13	01177	4	Drive Hub Thrust Bearing	48	02003	12	1/4"Nylon Male Pipe Thread Plug
14	01169	2	Drive Hub, Adjustment Side	49	02004	16	1/4" - 20 UNC X2 1/4" Ig. Stainless Steel Hex Head Bolt
15	01171	2	Large Eccentric	50	01538	2	End Cap
16	01172	2	Small Eccentric	51	01534	4	Cylinder Housing
17	01390	4	Drive Hub Adjusting Pin	52	01320	4	Intake Manifold Check Valve (BLUE)
18	01318	4	Wrist Pin Snap Ring	53	01537	2	Piston Wiper Support Ring
19	01317	2	Wrist Pin	54	01524	4	Piston Wiper
20	01167	4	Pump Connecting Slide	55	01391	2	1/4" x 2-1/4" Woodruff Key
21	01166	4	Pump Connecting Slide Cover	56	01516	2	Main Shaft O-Ring
22	01530	2	Piston Rod Retaining Block	57	01599	1	1-1/4" O.D. Main Shaft
23	01265	2	Piston Rod	58	02006	34	5/16" -18 UNC x 1" Long Stainless Steel Hex Head Bolt
24	01991	2	Piston Rod Guide Bushing O-Ring	59	01178	1	Right Half Drive Case
25	01992	2	Piston Rod Guide Bushing	60	01426	2	Drive Case Gasket
26	01993	2	Rear Stackpack Retainer O-Ring	61	02007	4	1/2" Nylon Male Pipe Thread Plug
27	01533	4	Stainless Steel Stackpack Retaining Snap Ring	62	01170	1	Drive Hub, Clutch Side
28	01312	8	Stackpack Washer	63	01173	2	Connecting Rod
29	01523	4	Stackpack	64	01179	1	Center Drive Case
30	01532	4	Stackpack Loading Spring	65	01174	1	Connector Drive Hub
31	01994	2	Rear Stackpack Retainer	66	01529	1	Adjustment Pointer Locking Plate
32	01175	2	Front Stackpack Retainer	67	00077	2	3/8" -16UNCx 1-1/4" Hex Head Bolt
33	01313	4	Stainless Steel Piston Thrust Washer	68	01653	1	Pump Adjusting Tool
34	01168	2	Piston	69	01582	1	Pump Rate Chart
35	01995	2	3/8" -16 UNC Stainless Steel Lock Nut				

**For reference only.  
Most of these parts have been replaced by new style parts.  
The housings are different though.**

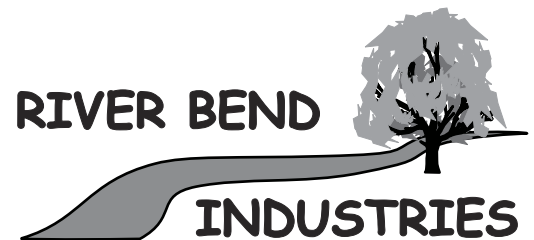

Moorhead, MN 56560  
218-236-1818  
800-365-3070  
[www.riverbendind.com](http://www.riverbendind.com)