

Models 1536, 1537, 1538, 1539 and 1540

Models 1536-SP, 1537-SP, 1538-SP, 1539-SP and 1540-SP

**RIVER BEND
INDUSTRIES**

Moorhead, MN 56560
218-236-1818
800-365-3070
www.riverbendind.com

1538 or 1538-SP for Self Priming
Unassembled pump kit
Pump portion only

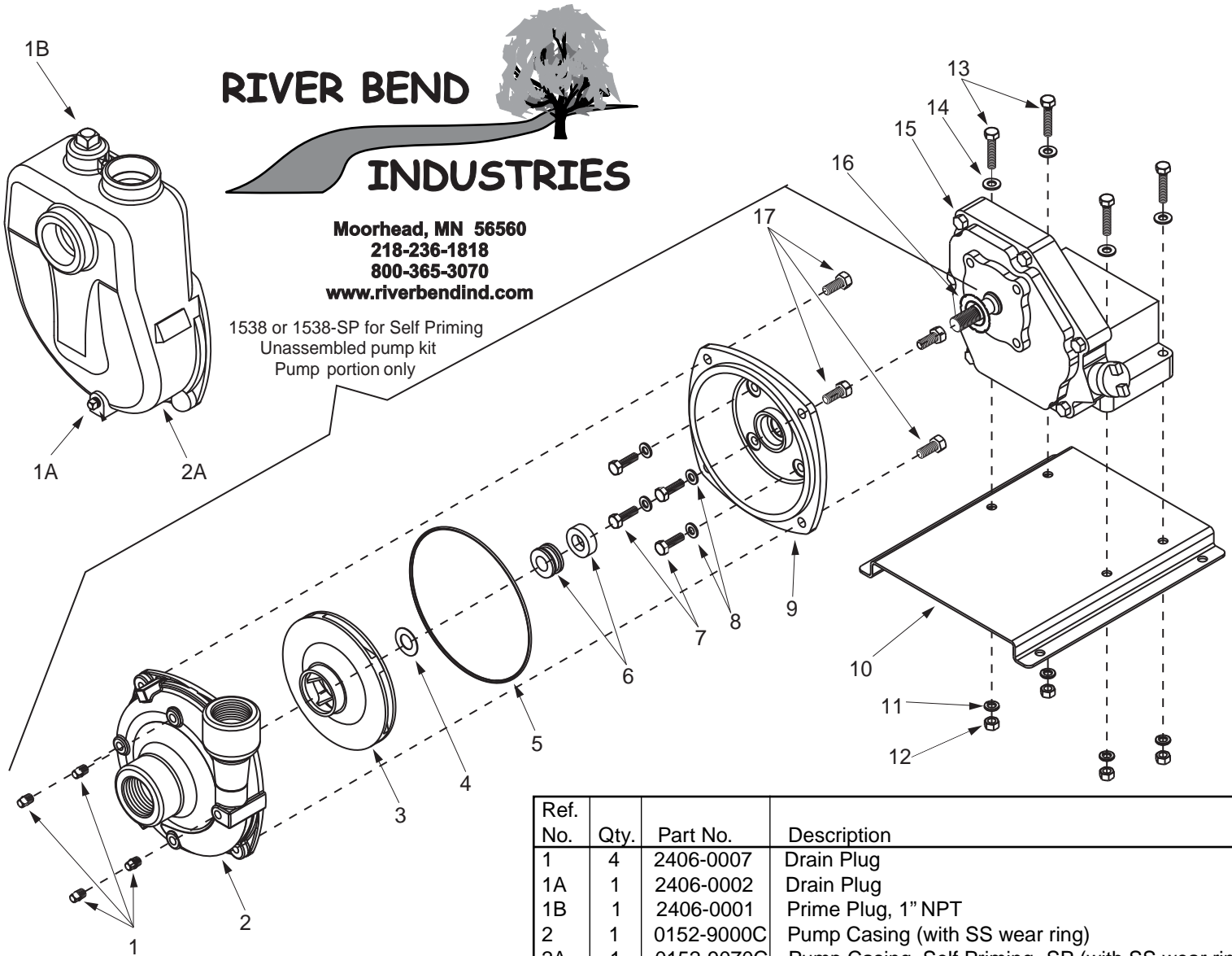

Seal Kit for 1536 thru 1540 (Std.)
No. 3430-0332 consists of:
(1) Ref. 4 Gasket
(1) Ref. 5 O-Ring
(1) Ref. 6 Mechanical seal

Seal Kit for 1536 thru 1540 (Opt.)
No. 3430-0589 (Silicon carbide)
consists of:
(1) Ref. 5 O-Ring
(1) Ref. 6 Mechanical seal

Note: When ordering parts, give quantity, part number, description and complete model number. Reference numbers are used ONLY to identify parts in the drawing and NOT to be used as order numbers.

Ref. No.	Qty.	Part No.	Description
1	4	2406-0007	Drain Plug
1A	1	2406-0002	Drain Plug
1B	1	2406-0001	Prime Plug, 1" NPT
2	1	0152-9000C	Pump Casing (with SS wear ring)
2A	1	0152-9070C	Pump Casing, Self Priming -SP (with SS wear ring)
3	1	0402-9200P	Impeller (Nylon)
4	1	1700-0100	Gasket
5	1	1720-0083	O-ring
6	1	2120-0009	Mechanical Seal - Viton
7	4	2210-0098	Bolt
8	4	1700-0119	Seal
9	1	0703-9200C	Flange
10	1	1510-0083	Mounting Plate
11	4	2260-0002	Lock Washer
12	4	2250-0003	Nut
13	4	2210-0021	Bolt
14	4	2270-0040	Washer
15	1	2541-0033	Briggs & Stratton Engine (135232-0035-01) * (Model 1536 and 1539)
15	1	2541-0034	Honda Engine GX160K 1 Type-TX2* (Model 1537)
15	1	2541-0035	Honda Engine GX160KIT1C3 (Model 1540)
16	1	1410-0088	Bearing Shield (5 HP Briggs)
16	1	1410-0105	Bearing Shield (5.5 HP Briggs)
17	4	2210-0020	Bolt

* Contact the engine manufacturer for this product number.