

Moorhead, MN 56560
218-236-1818
800-365-3070
www.riverbendind.com

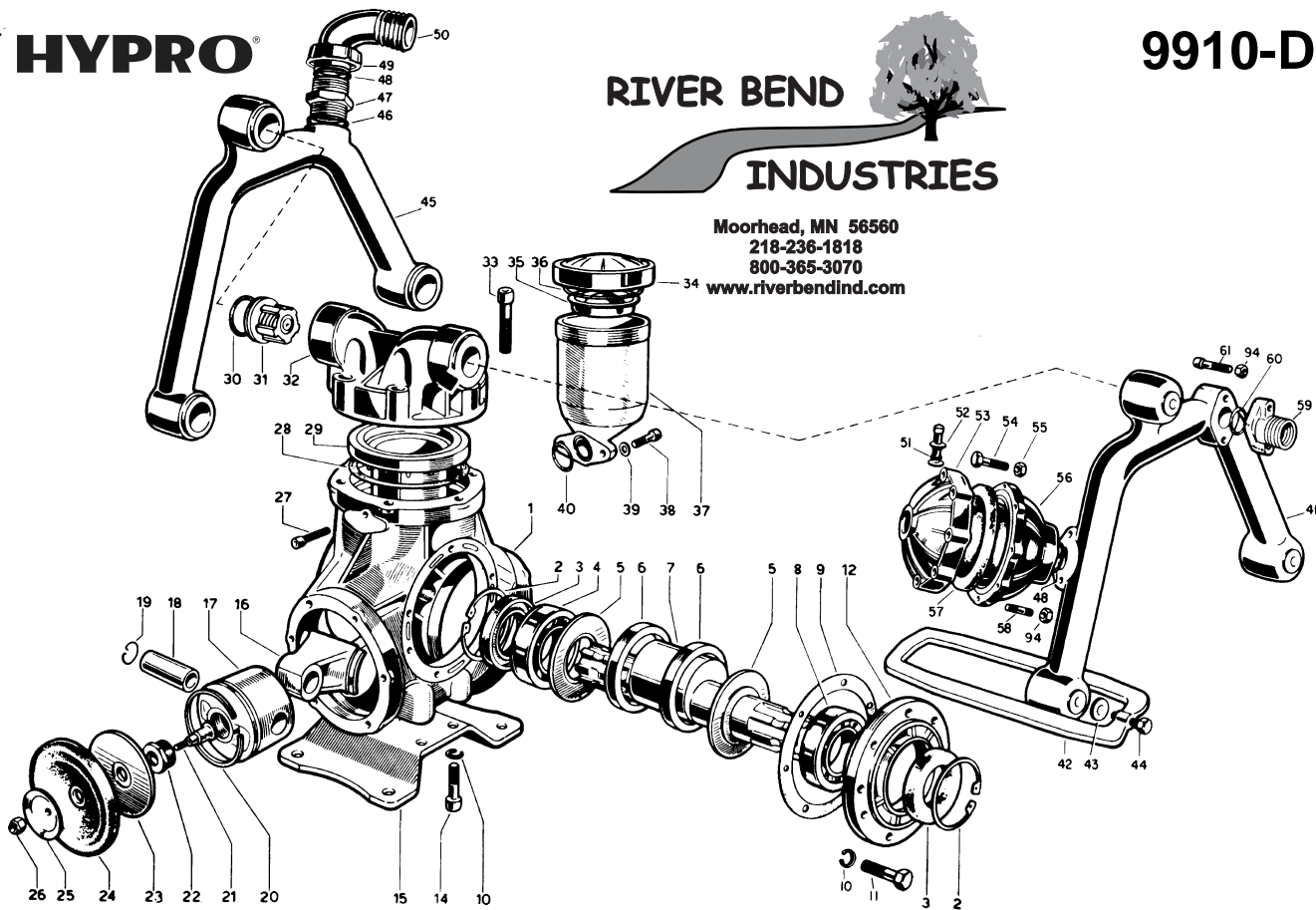

REF. NO.	PART NUMBER	DESCRIPTION	QTY. REQ'D
1	9910-680010	Pump Body	1
2	9910-200390	Retainer Ring	2
3	9910-230380	Seal	2
4	9910-161060	Ball Bearing	2
5	9910-680160	Spacer	2
6	9910-680130	Retainer Ring	2
7	9910-680780	Crankshaft-Splined Both Ends	1
8	9910-230350	Ball Bearing	1
9▲	9910-680250	Gasket	1
10	9910-200231	Lock Washer	10
11	9910-180160	Bolt 10 x 30	6
12	9910-680020	Bearing Support Housing	1
14	9910-160670	Bolt, 10 x 25	4
15	9910-680200	Pump Base	1
16	9910-680140	Connecting Rod	4
17	9910-650121	Piston	3
18	9910-650071	Connecting Rod Pin	4
19	9910-160691	Retaining Ring	6
20	9910-650190	Piston Ring	3
21	9910-650320	Retaining Bolt	3
22	9910-650610	Lock Nut	3
23	9910-650090	Diaphragm Support Washer	3
24■	9910-680085	Diaphragm	3
25	9910-650390	Retaining Washer	3
26	9910-160311	Lock Nut	3
27	9910-480870	Bleeder Bolt	1
28▲	9910-320280	Gasket	4
29	9910-680110	Sleeve w/Bleed Hole	1
29A	9910-680111	Sleeve	2
30▲■□	9910-680070	O-Ring	6
31□	9910-659050	Check Valve Assembly	6

REF. NO.	PART NUMBER	DESCRIPTION	QTY. REQ'D
32	9910-680101	Head Assembly (Right Hand)	2
32	9910-680102	Head Assembly (Left Hand)	1
33	9910-680210	Bolt 10 x 50	18
34	9910-1800060	Oil Cap, Black	1
35	9910-1040060	Sealing Cap, (No Longer Used)	1
36▲	9910-1040060	O-Ring	1
37	9910-680031	Oil Reservoir	1
38	9910-680350	Bolt 8 x 35	2
39	9910-380241	Lock Washer	2
40▲	9910-390180	O-Ring	1
41	9910-680280	Discharge Manifold	1
42	9910-680271	Retainer	3
43	9910-680260	Washer	3
44	9910-250140	Bolt 12 x 35	3
45	9910-680220	Suction Manifold	1
46▲	9910-250310	O-Ring	3
47	9910-580030	Threaded Adapter	1
48▲	9910-390290	O-Ring	2
49	9910-580060	Barb Nut	1
50	9910-580040	1-1/4" Hose Barb-Inlet	1
51▲	9910-650542	O-Ring	1
52	9910-180020	Air Valve	1
53	9910-620230	Accumulator Head	1
54	9910-380250	Bolt 8 x 45	8
55	9910-390270	Nut	8
56	9910-680180	Accumulator Head	1
57■	9910-550190	Accumulator Diaphragm	1
58	9910-390670	Accumulator Stud	2
59	9910-550391	NPT Fitting	1
60▲	9910-550350	O-Ring	6
61	9910-280080	Bolt 8 x 60	2
94	9910-380240	Nut 8 x H8	6

Repair and Maintenance Kits

▲ O-Ring/Gasket Kit No. 9910-KIT1737

Consists of: Ref 9 (1), Ref. 28 (3), Ref. 30 (6), Ref. 36 (1), Ref. 40 (1), Ref. 46 (1), Ref. 48 (2), Ref. 51 (1), Ref. 60 (1)

■ Diaphragm Parts Kit No. 9910-KIT 1726

Consists of: Ref. 24 (3), Ref. 30 (6), Ref. 57 (1)

□ Valve Parts Kit No. 9910-KIT1792

Consists of: Ref. 30 (6), Ref. 31 (6)