

Monarch ACT-SD SERIES

Side Discharge Centrifugal Pump
(Type A&B)

ACT-5SD, ACT-6SD, ACT-8SD
(For Belt or Coupling Drive)

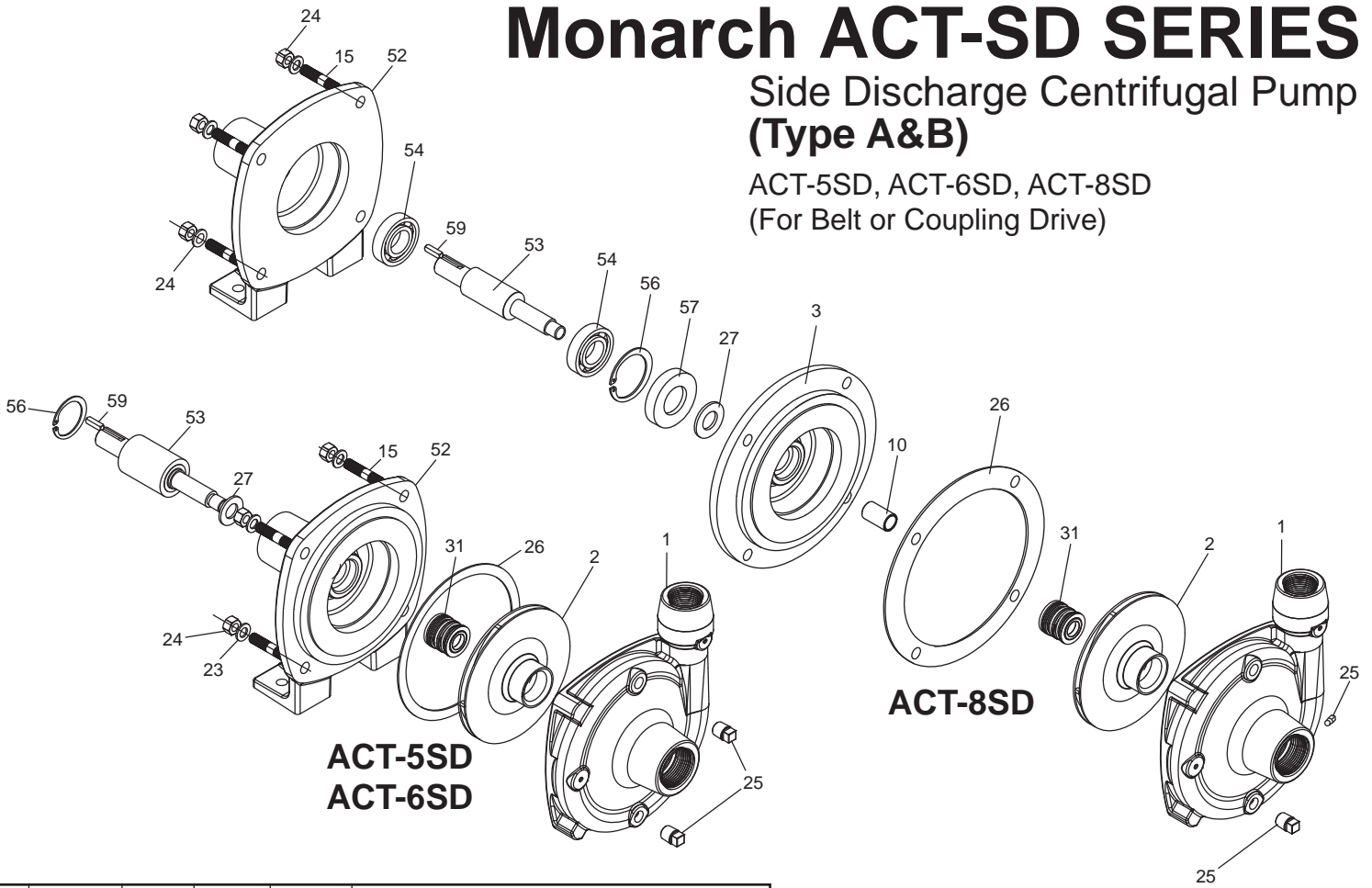

**ACT-5SD
ACT-6SD**

ACT-8SD

Ref. #	Part #	-5SD	-6SD	-8SD	Description
1	437842	1			Casing, 1-1/4" x 1"
	437865		1		Casing, 1-1/2" x 1-1/4"
	437839			1	Casing, 2" x 2"
2	433126	1			Impeller 5.3" Dia .395" Height
	433128		1		Impeller
	437813			1	Impeller
3	437812			1	Seal Plate
9	225750			1	Bolt 1/4" UNC x 1"
10	266008			1	Sleeve
13	175000			1	Washer Plain, 1/4 NOM
15	164631	4			Stud 3/8" x 1-1/2"
	164641		4	4	Stud 3/8" x 1-3/4"
23	176230	4	4	4	Washer Spring 3/8 NOM
24	227830	4	4	4	Nut Hex 3/8"
25	185620	2	2	3	Pipe Plug 1/4"
26	193914	1			Gasket
	193913		1		Gasket
	198995			1	O-Ring #165
27	191791	1	1		Flinger
	190847			1	Flinger
31	240250	1	1		Mechanical Seal
	240180			1	Mechanical Seal
52	437871	1			Transmission Housing
	437872		1		Transmission Housing
	437851			1	Transmission Housing
53	438455	1	1		Shaft, 3/4" Input
	437852			1	Shaft (Ext. 1-29/64), 3/4" Input
	437854			1	Shaft (Ext. 1-47/64), 3/4" Input
54	110216			2	Ball Bearing
56	137930	1	1		Retaining Ring
	37982			1	Retaining Ring
57	199245			1	Lip Seal
59	432010	1	1		Key 3/16 x 3/16 x 3/4"
	432280			1	Key 3/16 Sq. x 1" (for shaft #437852)
	432015			1	Key 3/16 Sq. x 1-1/4" (for shaft #437854)
60	185910			1	Pipe Plug 1/8"

RIVER BEND



INDUSTRIES

Moorhead, MN 56560

218-236-1818

800-365-3070

www.riverbendind.com