

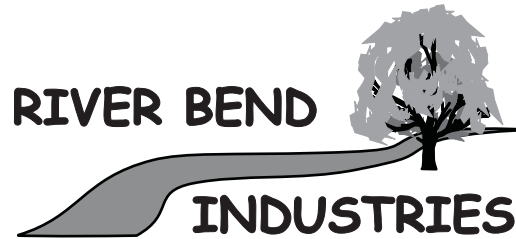

6010.23 Control Unit

Parts List



Moorhead, MN 56560
 218-236-1818
 800-365-3070
www.riverbendind.com

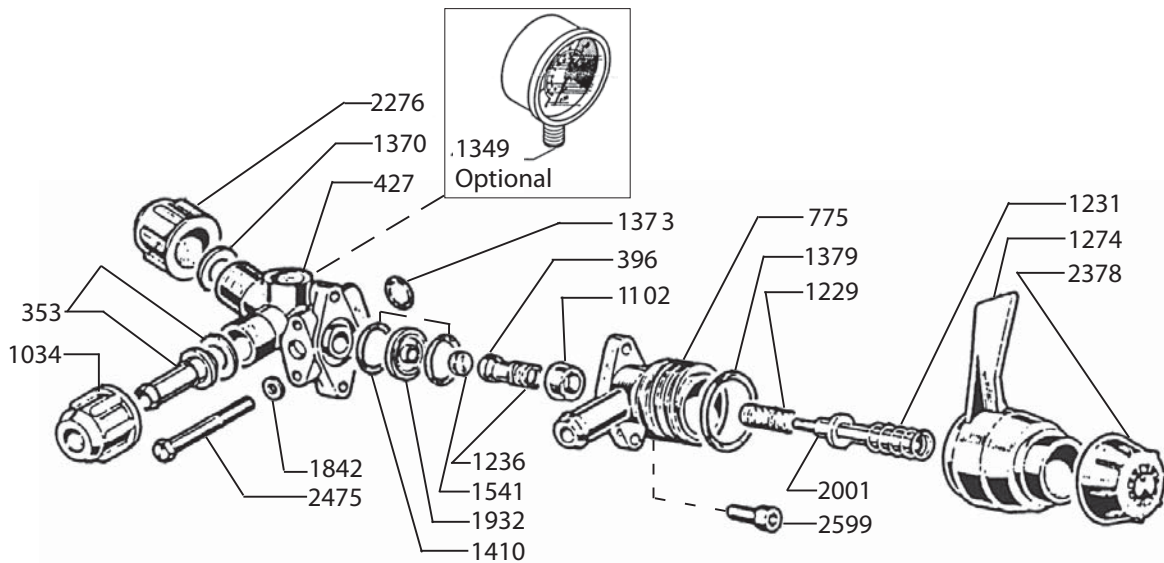

REF#	PA RT #	DESCRIPTION	QTY	REF#	PA RT #	DESCRIPTION	QTY
353	0202.09	3/8" Hose Barb	1	*1370	1101.06	O-Ring	1
*396		Valve Collar	1	*1373	1101.11	O-Ring	1
427	0204.41	Valve Body	1	*1379	1101.23	O-Ring	1
775	0252.01	By-pass Body	1	*1410	1101.69	O-Ring	2
1034	0604.09	Discharge Barb Nut	1	*1541		Poppet	1
*1102	0606.01	Seal	1	1842	1403.04	Washer	2
1229	0901.31	Spring	1	*1932		Seat	1
1231	0901.06	Spring	1	*2001		Stem	1
1236	0901.37	Spring	1	2276	1603.42	Cap	1
1274	0902.12	Regulator Handle	1	2378	1801.13	Adjustment Knob	1
1349	GG-350	Gauge (Optional)	1	2475	1804.61	Bolt	2
				2599	1805.37	Bolt	2

* Parts Included in Repair Kit - #8701.01.