

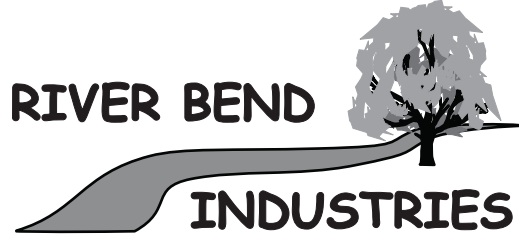

# 5027.75 Gear Reduction

## Installation Instructions & Parts List



For use with:  
 RO-70/GR-5  
 TAU-35/GR  
 KAPPA-30/GR  
 KAPPA-40/GR  
 KAPPA-35/GR  
 KAPPA-55/GR-5  
 ZETA-40P/GR  
 ZETA-85/GR  
 ZETA-85P/GR

Moorhead, MN 56560  
 218-236-1818  
 800-365-3070  
[www.riverbendind.com](http://www.riverbendind.com)

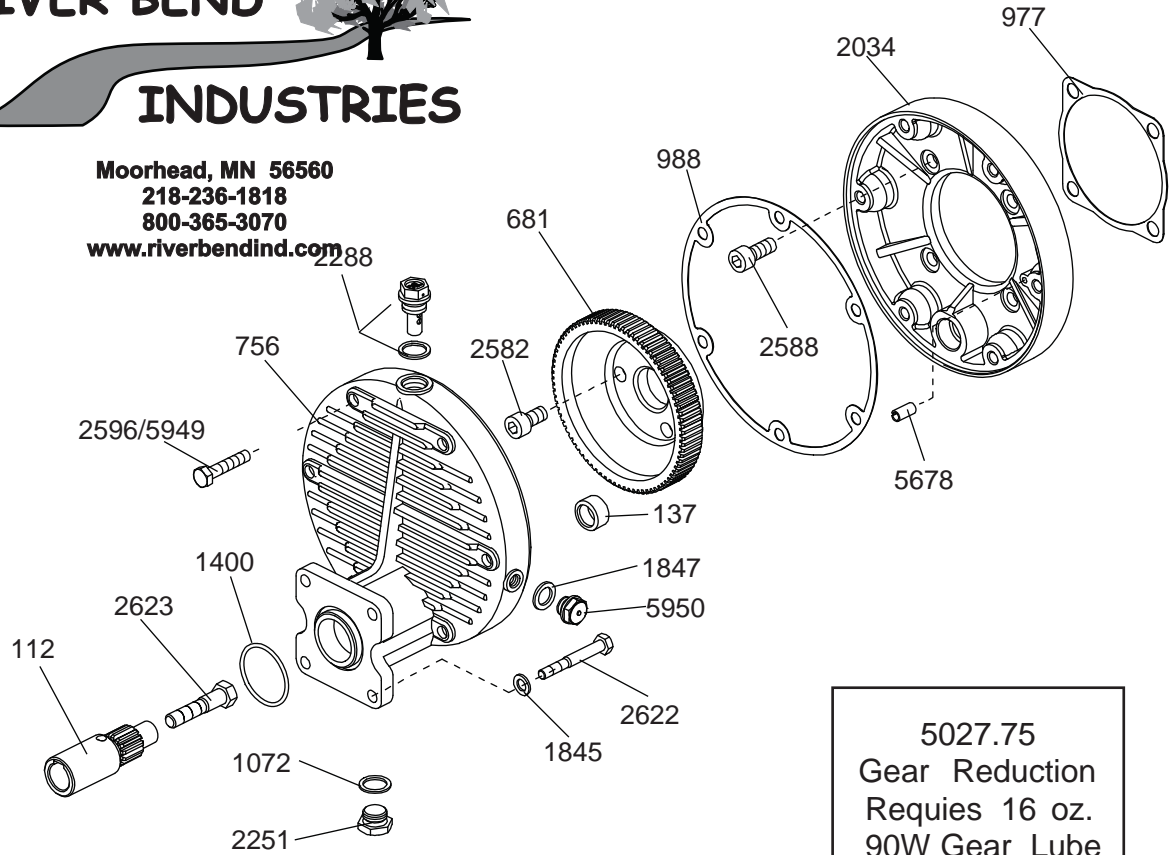

5027.75  
 Gear Reduction  
 Requires 16 oz.  
 90W Gear Lube

REF#	PART #	DESCRIPTION	QTY	REF#	PART #	DESCRIPTION	QTY
112	0004.18	Engine Gear	1	2251	603.02	Oil Plug	1
137	0006.08	Bearing	1	2288	1603.81	Vent Cap	1
681	0213.22	Pump Gear	1	2580	1805.01	Bolt	4
756	0228.23	Gear Case Half	1	2582	805.04	Bolt	3
977	0602.05	Gasket	1	2596*	1805.23	Bolt (old style) Allenhead	6
988	0602.27	Gasket	1	2622	1807.07	Bolt - 5/16" x 1"	4
1072	0605.01	Gasket	1	2623	1807.08	Bolt - 5/16" x 2-1/4"	1
1400	1101.57	O-Ring	1	5678	1512.08	Guide Pin	1
1845	1403.10	Washer	4	5950	1804.77	Side Plug	1
1847	1403.12	Aluminum Gasket	1	5949	1804.72	Bolt	6
2034	1505.29	Gear Case Half	1				

NOTE - USE BLUE THREADLOCKER OR EQUIVALENT ON ALL BOLTS.

1. Apply a light coating of anti-seize compound or grease to engine shaft and install 3/16" key, which is supplied with the engine.
2. Install engine gear (Ref #112) on engine shaft and secure with 5/16" x 2-1/4" bolt (Ref #2623) provided.
3. Install O-Ring (Ref #1400) into groove on gear box and mount assembly onto engine. Secure assembly to engine using the (4) 5/16" x 1" bolts (Ref #2622) and (4) washers (Ref #1845) provided.
4. Fill gear box with 16 oz. of 90W gear lube to level plug (Ref #5950).