

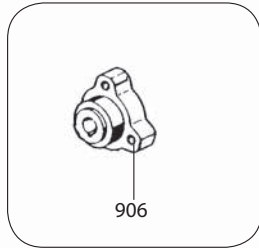

IOTA-17

Exploded View Diagram and Parts List



Ref #906 is needed to adapt the crank shaft to a standard 3-bolt mounting pattern for use with all shaft kits .

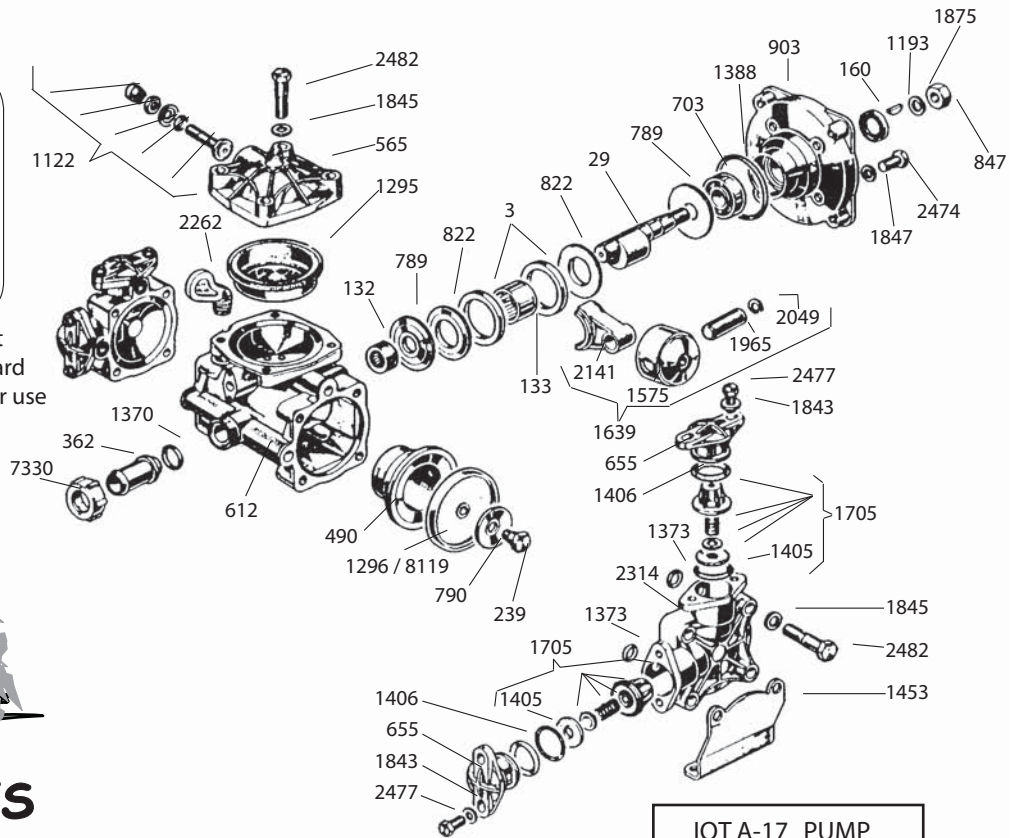

RIVER BEND



INDUSTRIES

**Moorhead, MN 56560
218-236-1818
800-365-3070
www.riverbendind.com**

IOTA-17 PUMP
Requires 7 oz.
UDOR LUBE
or SAE 30W
Non-detergent Oil

REF#	PART #	DESCRIPTION	QTY	REF#	PART #	DESCRIPTION	QTY
3	0001.04	Retainer Ring	2	*1373	1101.11	O-Ring	4
29	0002.10	Crankshaft	1	1378	1101.16	O-Ring	1
132	0006.01	Bearing	1	1387	1101.35	O-Ring	1
133	0006.02	Bearing	1	1388	1101.36	O-Ring	1
160	0007.11	Seal	1	1405	1101.10	O-Ring	4
239	0102.02	Diaphragm Bolt	2	1406	1101.17	O-Ring	4
362	0202.27	Suction Barb	1	1453	1202.17	Base	2
490	0206.16	Piston Sleeve	2	1575	1205.13	Aluminum Piston	2
565	0208.31	Accumulator Head	1	1639	6000.04	Piston & Rod Assembly	2
612	0209.19	Pump Body	1	1671	6010.23	Control Valve Assembly	1
655	0211.04	Valve Retainer	4	1705	6006.04	Valve Assembly	4
703	0214.08	Ball Bearing	1	1843	1403.07	Washer	8
789	0301.08	Washer	2	1845	1403.10	Washer	8
790	0301.09	Retainer Washer	2	1847	1403.12	Washer	4
822	0302.11	Pump Spacer	2	1875	1404.01	Washer	1
847	0303.10	Hex Nut	1	1965	1502.04	Connecting Rod Pin	2
903	0501.47	Flange	1	2049	1506.11	Snap Ring	4
906	0501.05	Crankshaft Adapter	1	2141	1519.07	Aluminum Connecting Rod	2
1122	0608.16	Air Valve Assembly	1	2262	1603.24	Plug	1
1193	0801.03	Key	1	2314	1604.30	Head	2
*1295	0903.08	Accumulator Diaphragm	1	2474	1804.57	Bolt	4
1296	0903.09	Piston Diaphragm (BUNA-N) optional	2	2477	1804.67	Bolt	8
1370	1101.06	O-Ring	1	2482	1804.09	Bolt	12
				7330	0604.29	Barb Nut	1
				*8119	0903.41	Piston Diaphragm (DESMOP AN)	2

* Parts Included in Diaphragm Repair Kit - #8700.01. (Also available in BUNA-N - #8700.08.)