



KAPPA-120 & KAPPA-120/CC

Exploded View Diagram and Parts List

RIVER BEND



INDUSTRIES

Moorhead, MN 56560
218-236-1818
800-365-3070
www.riverbendind.com

KAPPA-120 PUMPS
Require 84 oz. UDOR LUBE,
or SAE 30W Non-detergent Oil

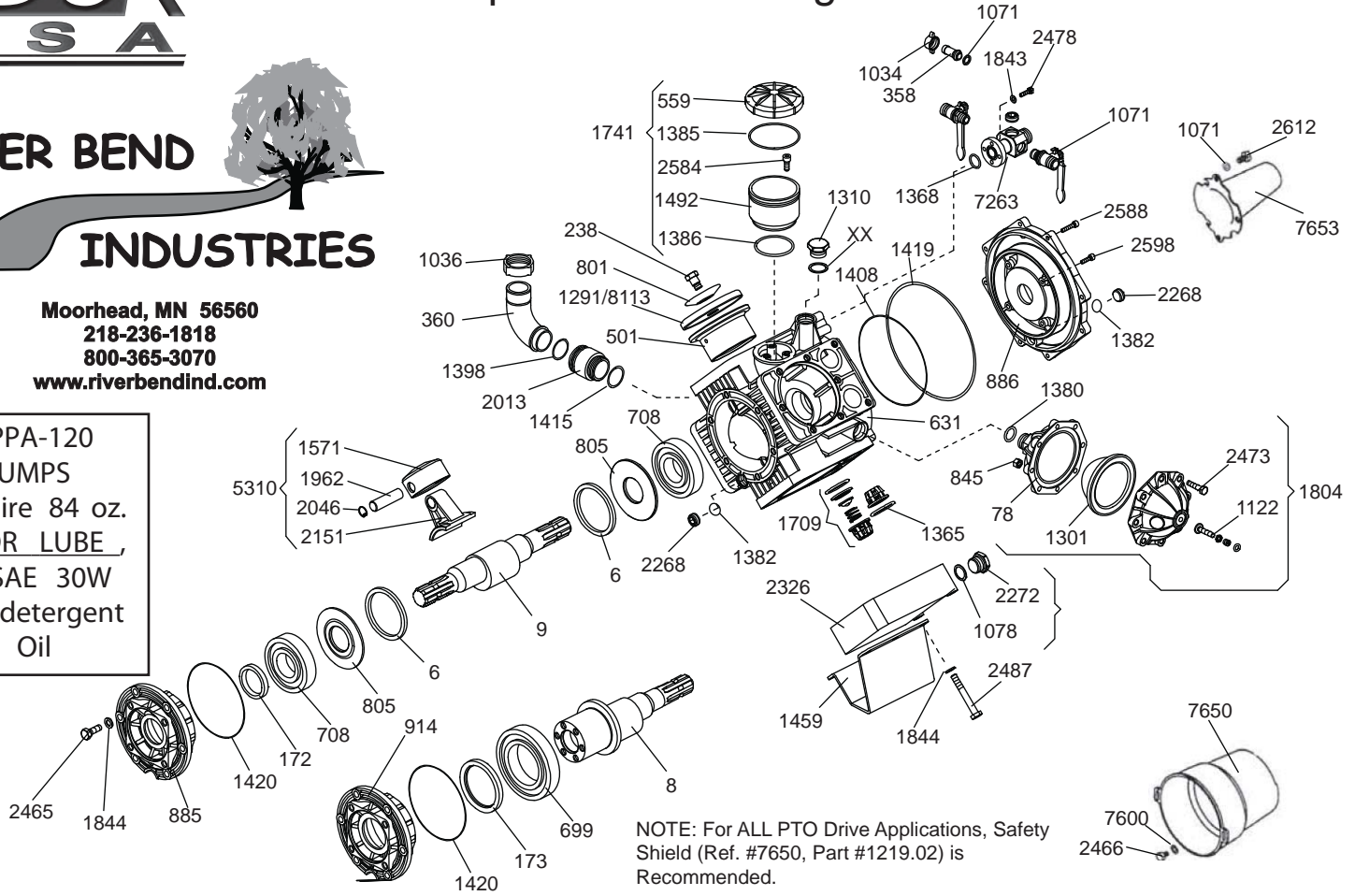

NOTE: For ALL PTO Drive Applications, Safety Shield (Ref. #7650, Part #1219.02) is Recommended.

REF#	PART #	DESCRIPTION	QTY
	6	0001.08 Retainer Ring	2
	8	0002.66 Crankshaft (KAPPA-120)	1
	9	0002.64 Crankshaft (KAPPA-120/CC)	1
	78	0003.10 Pressure Accumulator	1
	156	0007.02 Seal	1
	172	0007.34 Seal	1
	173	0007.35 Seal (KAPPA-120)	1
	238	0102.03 Diaphragm Bolt	4
	358	0202.19 Discharge Barb	2
	360	0202.84 Suction Elbow	1
	501	0206.28 Piston Sleeve	4
	558	0208.21 Accumulator Head	1
	559	0208.22 Oil Cap	1
	631	0209.33 Pump Body	1
	699	0214.03 Bearing (KAPPA-120)	2
	708	0214.16 Bearing	2
	747	0218.01 Air Valve Cap	1
	801	0301.07 Retainer Washer	4
	805	0301.34 Washer	2
	845	0303.01 Nut	8
	885	0501.81 Bearing Retainer (KAPPA-120/CC)	1
	886	0501.80 Body Flange	1
	914	0501.82 Bearing Retainer (KAPPA-120)	1
	1034	0604.09 Discharge Barb Nut	2
	1036	0604.48 Suction Nut, Brass	1
	1071	0605.05 Gasket	2
	1078	0605.42 Aluminum Gasket	8
	1122	0608.16 Air Valve Assembly	1
	1124	0608.45 Ball Valve	1
	1291	0903.02 Piston Diaphragm (BUNA-N) optional	4
	*1301	0903.16 Accumulator Diaphragm	1
	1310	1001.04 3/4" Adapter Fitting	1
	*1365	1101.01 O-Ring	8
	1368	1101.04 O-Ring	1
	1376	1101.16 O-Ring	1
	1380	1101.25 O-Ring	1
	1382	1101.29 O-Ring	2
	1385	1101.32 O-Ring	1

REF#	PART #	DESCRIPTION	QTY
	1386	1101.33 O-Ring	1
	1398	1101.42 O-Ring	1
	1408	1101.63 O-Ring	1
	1415	1101.77 O-Ring	1
	1419	1101.80 O-Ring	1
	1420	1101.71 O-Ring	1
	1459	1202.36 Mounting Rails	2
	1492	1203.30 Oil Reservoir	1
	1569	1205.06 Piston	4
	1709	6006.08 Valve Assembly	8
	1741	6033.02 Oil Reservoir Assembly	1
	1804	6031.02 Accumulator Assembly	1
	1843	1403.07 Washer	4
	1844	1403.09 Washer	26
	1845	1403.10 Washer	2
	1962	1502.01 Connecting Rod Pin	4
	2013	1504.04 Nipple	1
	2046	1506.02 Snap Ring	8
	2151	1519.24 Connecting Rod	4
	2268	1603.32 Body Plug	2
	2272	1603.A3 Head Plug Brass	8
	2326	1604.51 Head	4
	2465	1804.03 Bolt	6
	2466	1804.06 Bolt	2
	2473	1804.54 Bolt	8
	2478	1804.68 Bolt	4
	2487	1804.25 Bolt	32
	2584	1805.06 Bolt	3
	2588	1805.21 Bolt	8
	2598	1805.31 Bolt	4
	2612	1805.47 Bolt	2
	5003	0608.46 Ball Valve, Right	1
	5310	6015.36 Piston/Rod Assembly	4
	7263	0508.13 Discharge Manifold	1
	7600	1403.36 Washer	2
	7650	1219.02 PTO Safety Shield, optional	1
	7653	1219.15 Thru-Shaft Protector	1
	*8113	0903.34 Piston Diaphragm (DESMOPAN)	4

* Parts Included in diaphragm Repair Kit - #8700.22 (Also available in Buna-N - 8700.21))