

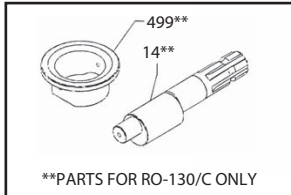

RO-110/C & RO-130/C Exploded View Diagram and Parts List

RO-110/C &
RO-130/C PUMPS
Require 30 oz.
UDOR LUBE,
or SAE 30W
Non-deter gent Oil

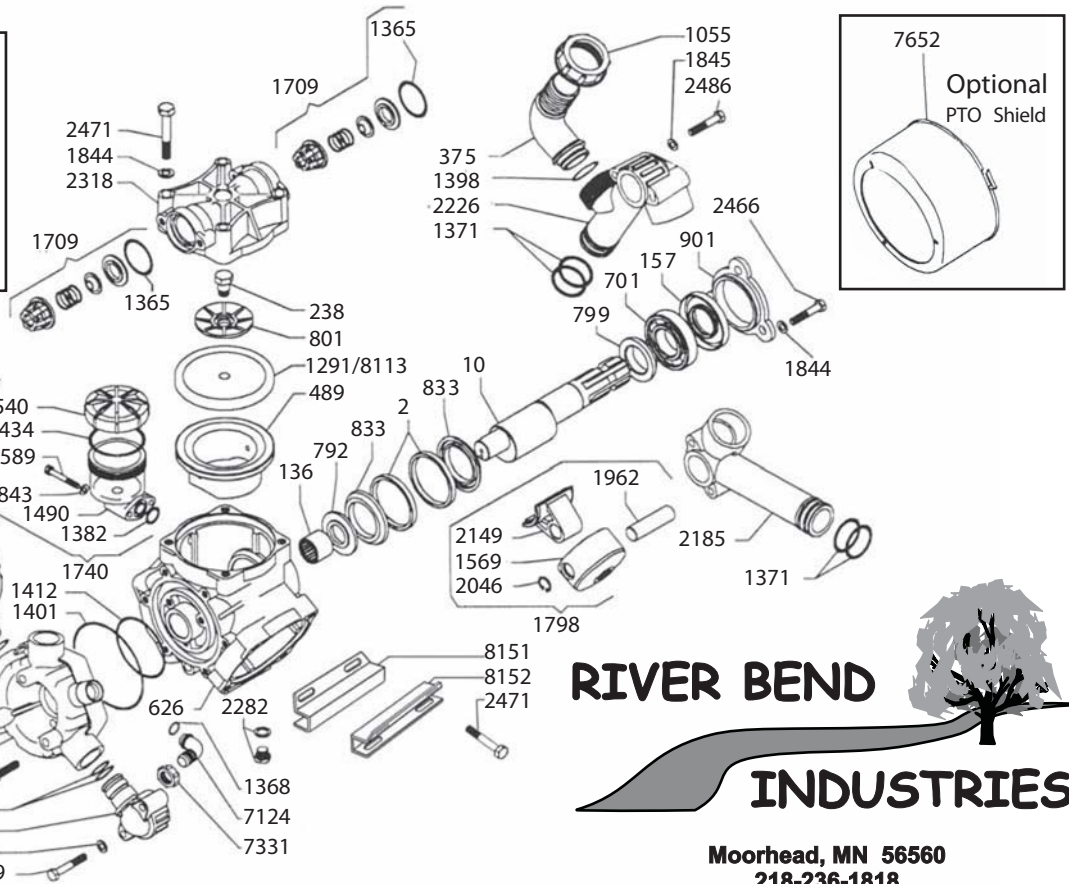

**RIVER BEND
INDUSTRIES**

Moorhead, MN 56560
218-236-1818
800-365-3070
www.riverbendind.com

| REF# | PA RT # | DESCRIPTION | QTY | REF# | PA RT # | DESCRIPTION | QTY |
|-------|---------|-------------------------------|-----|-------|---------|----------------------------------|-----|
| 2 | 0001.02 | Retainer Ring | 2 | 1401 | 1101.58 | O-Ring | 1 |
| 10 | 0002.59 | Crank Shaft | 1 | 1412 | 1101.79 | O-Ring | 1 |
| **14 | 0002.63 | Crank Shaft (RO-130/C ONLY) | 1 | 1434 | 1101.D1 | O-Ring | 1 |
| 81 | 0003.15 | Accumulator | 1 | 1490 | 1203.27 | Oil Reservoir | 1 |
| 136 | 0006.07 | Bearing | 1 | 1497 | 1203.36 | Manifold Elbow | 3 |
| 157 | 0007.05 | Seal | 1 | 1569 | 1205.06 | Piston | 3 |
| 238 | 0102.03 | Diaphragm Bolt | 3 | 1709 | 6006.08 | Valve Assembly | 6 |
| 375 | 0202.78 | Suction Elbow | 1 | 1740 | 6033.01 | Oil Reservoir Assembly | 1 |
| 489 | 0206.14 | Piston Sleeve | 3 | 1798 | 6015.24 | Piston Rod Assembly | 3 |
| **499 | 0206.26 | Piston Sleeve (RO-130/C ONLY) | 3 | 1811 | 6031.09 | Accumulator Assembly | 1 |
| 540 | 0208.98 | Oil Cap | 1 | 1843 | 1403.07 | Washer | 2 |
| 557 | 0208.20 | Accumulator Head | 1 | 1844 | 1403.09 | Washer | 11 |
| 626 | 0209.34 | Crank Case | 1 | 1845 | 1403.10 | Washer | 18 |
| 647 | 0257.07 | Dischar ge Manifold | 1 | 1962 | 1502.01 | Connecting Rod Pin | 3 |
| 701 | 0214.05 | Bearing | 1 | 2046 | 1506.02 | Snap Ring | 6 |
| 747 | 0218.01 | Air Valve Cap | 1 | 2149 | 1519.16 | Connecting Rod | 3 |
| 792 | 0301.12 | Washer | 1 | 2185 | 1601.13 | Suction Manifold | 2 |
| 799 | 0301.24 | Washer | 1 | 2226 | 1602.22 | Suction Manifold | 1 |
| 801 | 0301.07 | Retainer Washer | 3 | 2282 | 1603.50 | Drain Plug | 1 |
| 833 | 0302.52 | Rod Spacer | 2 | 2318 | 1604.36 | Head | 3 |
| 845 | 0303.01 | Nut | 6 | 2466 | 1804.06 | Bolt | 3 |
| 901 | 0501.45 | Flange | 1 | 2471 | 1804.29 | Bolt | 12 |
| 1055 | 0604.50 | Barb Nut | 1 | 2482 | 1804.09 | Bolt | 6 |
| 1122 | 0608.16 | Air Valve Assembly | 1 | 2486 | 1804.79 | Bolt | 6 |
| 1291 | 0903.02 | Diaphragm (BUNA-N, Optional) | 3 | 2589 | 1805.31 | Bolt | 2 |
| *1300 | 0903.14 | Accumulator Diaphragm | 1 | 2581 | 1805.03 | Bolt | 9 |
| *1365 | 1101.01 | O-Ring | 6 | 5949 | 1804.72 | Bolt | 6 |
| 1368 | 1101.04 | O-Ring | 1 | 7124 | 0253.05 | Dischar ge Elbow | 1 |
| 1371 | 1101.07 | O-Ring | 6 | 7331 | 0604.36 | Dischar ge Nut | 1 |
| 1376 | 1101.16 | O-Ring | 1 | 7652 | 1219.25 | PTO Safety Shield Optional | 1 |
| 1380 | 1101.25 | O-Ring | 7 | *8113 | 0903.34 | Diaphragm (DESMOP AN, Standar d) | 3 |
| 1382 | 1101.29 | O-Ring | 1 | 8151 | 1202.63 | Mounting Rail - Right Side | 1 |
| 1398 | 1101.42 | O-Ring | 1 | 8152 | 1202.64 | Mounting Rail - Left Side | 1 |

* Parts Included in Diaphragm Repair Kit - #8700.04. (Also available in Buna-N - #8700.11.)

** Parts for RO-130/C only